

Customer Information Sheet

IF IN DOUBT - ASK



NOT TO SCALE

THIRD ANGLE PROJECTION

ALL DIMENSIONS IN mm

High requirements for terminal riveting:

CH-1	1.34~1.40
CH-2	1.36~1.42
CH-3	1.28~1.34

*XXXX (The size can be customized)

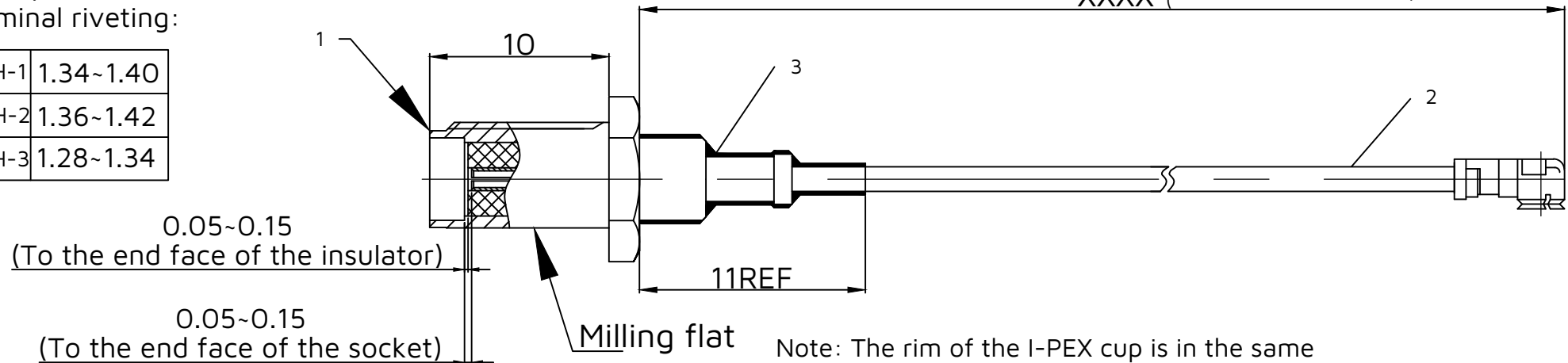

Note: The rim of the I-PEX cup is in the same direction as the milling plane of the SMA

4. The black dust cap needs to be put on the connector

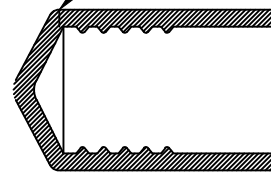

Nut

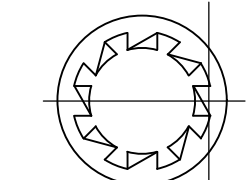
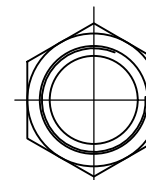

Gasket

Technical Requirements:

- 100% open circuit and short circuit testing:
Withstand voltage: AC 500V, Current: 0.05mA
Insulation: DC 500V, Insulation resistance :500MΩ
- Frequency: DC-6GHz standing wave ≤1.5, insertion loss ≤1.1dB
- The materials used in this cable assembly must comply with the RoHS standard.

0-500mm	±5mm
501-1000mm	±10mm
>1000mm	±20mm

4	Black dust cap	1	KC	1	03JUL25	--
3	Ø4.2 Black rubber-containing sleeve	1	NAME	ISS.	DATE	CN/CO
2	Ø1.37 black silver-tin wire single-ended first-generation genuine product	1	APPROVED: WALKER/MEIZY			
1	SMA female head and female needle (with ring)	1	CHECKED: THIRI			
NO.	NAME	Q'TY	DRAWN: KC			



www.harwin.com

TOLERANCES
X. = ±1mm
X.X = ±0.50mm
X.XX = ±0.20mm
X.XXX = ±0.01mm
ANGLES = ±5-
UNLESS STATED

THIS DRAWING AND ANY INFORMATION OR DESCRIPTIVE MATTER SET OUT HEREON ARE CONFIDENTIAL AND COPYRIGHT PROPERTY OF THE HARWIN GROUP AND MUST NOT BE DISCLOSED, LOANED, COPIED OR USED FOR MANUFACTURING, TENDERING OR FOR ANY OTHER PURPOSE WITHOUT THEIR WRITTEN PERMISSION.

MATERIAL & FINISH:

SEE ABOVE

TITLE:
SMA+1.37 Black Cable+IPEX

DRAWING NUMBER:
MMCB-010706XXXX-S-001

SHT
1
OF
1